

BOSS-Sprayer Model 421672

Instructions

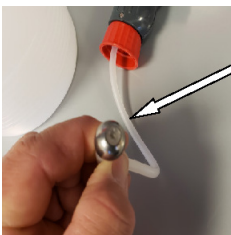

Read these instructions carefully before first use.
Intended use, only use Multi-Clean EZ-Sprayer for applying cleaners and disinfectants that are neutral or pH between 1-7. Observe guidelines and warnings provided by original chemical product container. Do not use liquids above 104F. Inspect sprayer before any use. Only use sprayer in an operationally safe condition. Charge battery before first use by connecting USB charging cable to a power source and the back of sprayer body. Charge for 1.5 to 2 hours.

Do not operate sprayer without liquid.
Do not use sprayer in rain or windy conditions.
Point sprayer nozzle towards target object at a distance of approximately 20 inches.
Push trigger button to start spray, release button to stop sprayer.
Adjust spray pattern by turning nozzle counter-clockwise to produce a narrow stream. Turn clockwise to produce mist pattern.

Cleaning and storage, empty sprayer, flush sprayer with clean water, run clean water through sprayer by activating sprayer. Let sprayer dry after cleaning.

Battery may be low on charge.
Connect USB power cable and charge for 2.5 hours.

If reduced performance/loss of pressure is experienced, remove the pump unit from the tank.

Check the pick-up/filter connected to the end of the hose assembly. It may be necessary to clean the mesh filter screen in the pick-up.

Soak the pick-up screen in a warm soapy water solution. If an extreme blockage is determined a small pick can aid in cleaning the mesh screen in the pick-up.



Triggerless, Rechargeable Sprayer

Multi-Clean®
Your Guide to Clean

600 Cardigan Road
Shoreview, Minnesota

Instructions 004251
27072022

Multi-Clean®
Your Guide to Clean