

# Dilution Control Systems

**Single-Blend**  
Single Button Model  
421300

OPERATION

SERVICE

PARTS

CARE



# Set Up

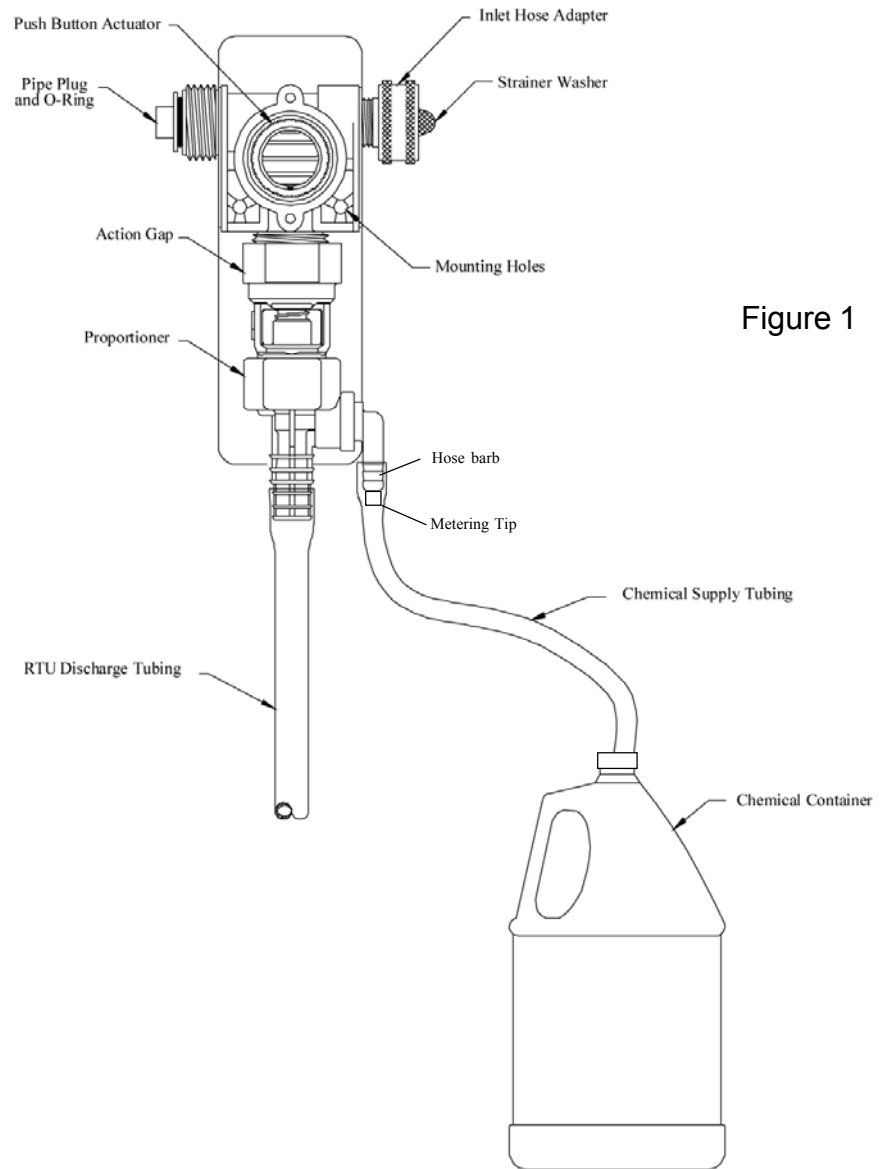

## Mounting Instructions

1. Remove all parts from carton.
2. Remove 2 cover screws.
3. Use mounting holes to secure unit to wall.
4. Replace cover and screws.
5. Locate and mount bottle rack to wall within 40" of single blend button. Chemical supply hoses are 46" long.

## Operating Instructions

1. Place discharge hose in container to be filled and press button to begin filling.
2. To fill large containers, lock trigger on by sliding lock forward while in the on position.
3. When product container is empty, remove cap assembly and attach new container.

## Set Up Instructions

1. Remove all parts from carton.
2. Connect water supply hose to unit.
3. Connect RTU discharge hose.
4. Insert tip in hose barb, refer to figure 4 for tip color.
5. Connect chemical supply hose to hose barb.
6. Thread cap onto product bottle.
7. Turn water supply on at spigot.

## Gang Instructions

To create a two button station, refer to figure 1. Remove pipe plug and o-ring, attach second single blend button to this connection, tighten. Refer to set up instructions above, items 3-7.

# Parts List

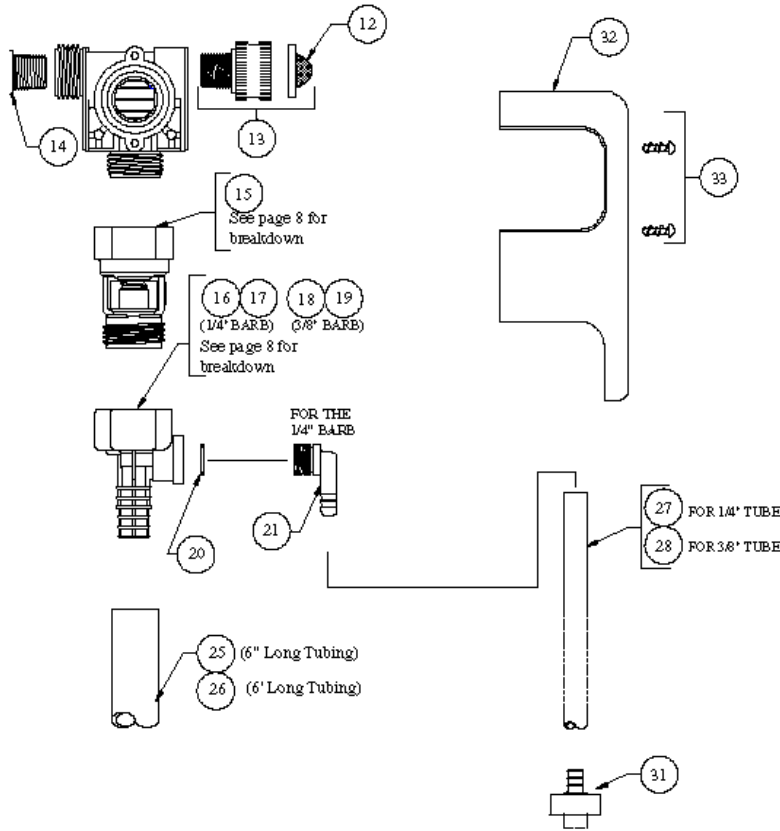

Figure 2

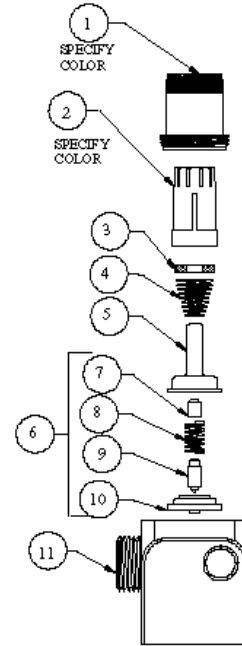

Figure 3

NO.	PART NO.	DESCRIPTION
1	66-139	Magnet Housing (Specify Color)
2	66-140	Push Button (Specify Color)
3	63-35	Magnet
4	63-36	Spring
5	41-7-25	Enclosing Tube
6	63-87	Valve Repair Kit
7	63-37	Spacer
8	41-1-8	Kick-off Spring
9	63-38	Plunger
10	41-15-10	Diaphragm
11	63-39	Valve Body
12	100-38	Strainer Washer
13	93-44	Swivel Adapter w/Strainer Washer
14	66-153	Pipe Plug & O-Ring Assy.
15	16-30	Action Gap Assembly
16	61-22-3	4 GPM (1/4" Barb) Prop. (Gray)
17	61-99-2	1 GPM (1/4" Barb) Prop. (Green)
18	61-22-2	4 GPM (3/8" Barb) Prop. (Gray)
19	61-99-1	1 GPM (3/8" Barb) Prop. (Green)
20	63-78	O-Ring

NO.	PART NO.	DESCRIPTION
21	63-79	Inlet Barb (1/4" Barb)
22	63-80	Inlet Barb (3/8" Barb)
23	100-15K	Metering Tip Kit (14 Sizes) (1/4" Barb)
24	61-9K	Metering Tip Kit (15 Sizes) (3/8" Barb)
25	16-3-6	1/2" ID X 6" Lg. Vinyl Outlet Tube (1 GPM Only)
26	61-21	1/2" ID X 6" Lg. Vinyl Outlet Tube (4 GPM Only)
27	100-12	1/4" ID X 8' Lg. Vinyl Supply Tubing
28	100-12L	3/8" ID X 8' Lg. Vinyl Supply Tubing
31	100-16E	Cap hose asm
32	63-45	Cover
33	63-46	Screws (2 Req'd)

# Single-Blend Model 421300

## THANK YOU FOR YOUR INTEREST IN OUR PRODUCTS

Please use this equipment carefully and observe all warnings and cautions.

\*\*\*\*\* NOTE \*\*\*\*\*

**WEAR** protective clothing and eyewear when dispensing chemicals, emptying equipment or changing metering tips.

**ALWAYS** observe safety and handling instructions

**ALWAYS** direct discharge away from you or other persons or into approved containers.

**ALWAYS** dispense cleaners and chemicals in accordance with instructions.  
Exercise **CAUTION** when maintaining your equipment.

**KEEP** equipment clean to maintain proper operation.

**ALWAYS** re-assemble equipment according to instruction procedures. Be sure all components are firmly screwed or latched into position.

**ATTACH** only to tap water outlets (25 PSI minimum, 85 PSI maximum).

### Single-Blend tip chart

1 GPM (3.7LPM)

Product	Tip Color
2 Glass & Surface Cleaner	Green
3 Soap Scum Remover	Red
4 Foamy Mac	Red
5 Neutral Cleaner	Purple
8 Super D Degreaser	Turquoise
10 MC-10 Sanitizer	NA
12 HD Hi-Foam	Red
15 Power Suds	Tan

Figure 4



600 Cardigan Road  
Shoreview, Minnesota 55126  
Phone 651-481-1900  
www.multi-clean.com

988449  
Printed in U.S.A.