

Parts List

Part #	Qty.	Description
A	1	Cross-Member
B	2	Side Frame
C	2	Cross-Member w/Mounting Holes
H	1	Handle
K	4	1/4 x 2 PH Screw
L	4	1/4 Locknut
M	1	5/8 D Axle
N	2	10" K16 Wheel
O	8	5/8 ID Washer
P	4	Cotter Pin

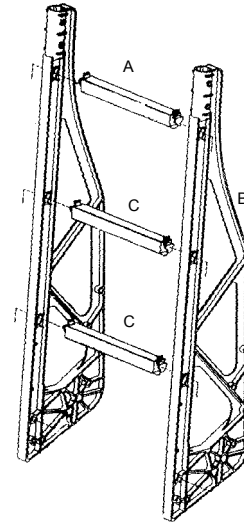

ASSEMBLY PROCEDURE:

1. Insert cross-member (A) in top holes of side frames. Insert cross-members (C) (pre-drilled mounting holes for Versa-Station) in bottom 2 holes.
2. Insert the handle (H) into the side frame (B) socket and secure with fasteners (K&L).
3. Slide axle (M) through side frame (B) axle hole as shown. Insert 2 washers (O) on the axle between the frames.
4. Install 2 cotter pins (P) in the axle between the side frames with the washer between the cotter pin and side frame.
5. Assemble the wheels onto the axle with 2 washers on the inside and 1 outside the wheel. Secure with a cotter pin (P) through the end of the axle (M).

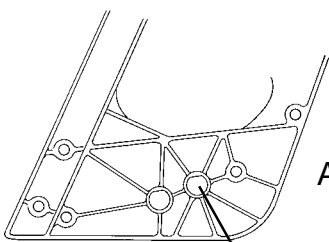
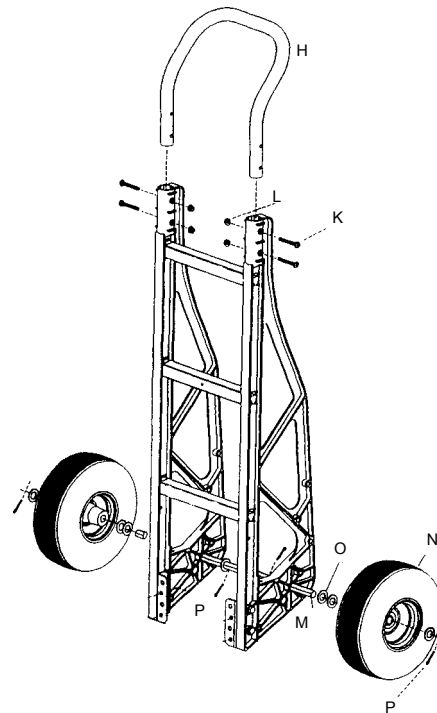

Axle placement

Use these holes for axle

Multi-Clean®

Mounting Instructions Rack 421270/421290 to Cart

Part #	Qty.	Description
D	1	Chemical Rack Part #421270
E	2	#8-32 x 1 3/4" Machine Screw
F	2	#8-32 x 1 1/2" Machine Screw
G	2	1" Flat Washer
I	6	#8 SAE Flat Washer
J	4	#8-32 Hex Nut
Q	4	Snap-On Feet

ASSEMBLY PROCEDURE:

1. Position rack (D) with holes on cross-member (C) on cart.
2. Insert 1 3/4" machine screw (E), #8 flat washer (I) and 1" flat washer (G) through rack as shown.
3. Install #8 flat washer (I) and #8-32 hex nut (J) onto machine screw (E) and hand tighten.
4. Insert 1 1/2" machine screws (F) with flat washers as shown through rack (D) and lower cross-member (C) and install hex nut (J) with flat washer (I) on back of cross-member (C)
5. Tighten all hex nuts (J).
6. Snap on feet (Q) to outside rails (as shown).

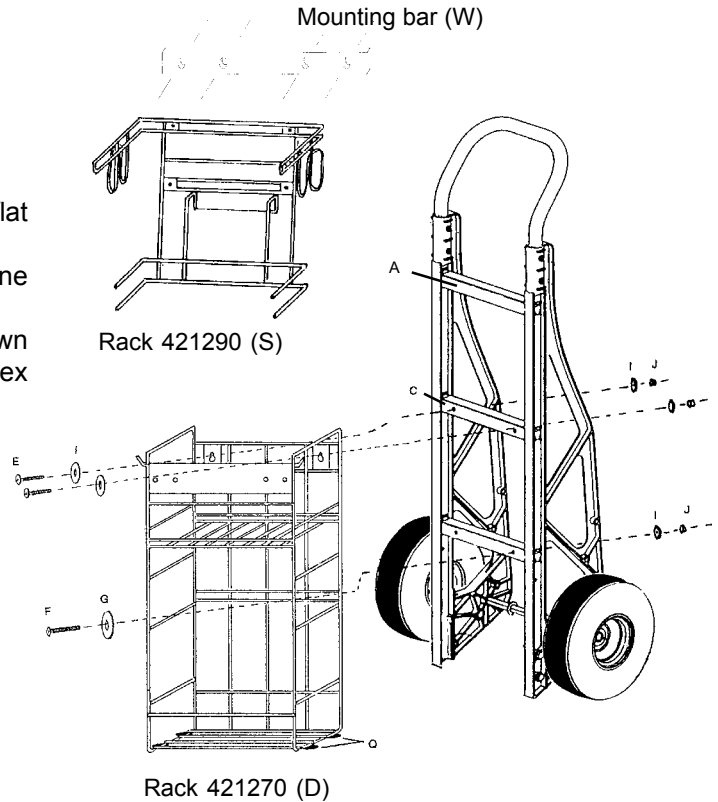
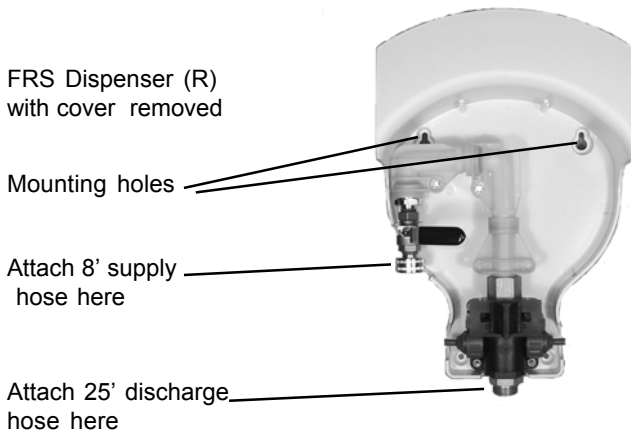

Parts List

R.	FRS unit
S.	FRS rack #421290
T.	1/4 - 20 x 1/2" machine screw
U.	1/4 20 hex nut and washer
V.	1/4 - 20 x 2 1/2" machine screw
W.	Mounting bar

NOTE: Attach 25' discharge hose to FRS prior to assembling FRS to rack.

1. Remove cover of FRS unit. Locate holes for mounting on back of unit. Line up holes with rack unit (S) using 4 1/4-20x1/2" bolts (T) enclosed and attach to rack using hex nuts, and washers (U).
2. Remove top bolt(K) on each side of cart which holds handle to cart, leaving bottom bolt in place.
3. Hook bottom of rack 421290 to top support bracket (A) of mobile cart.
4. Insert bolt (V) into handle holes and rack and secure to cart using hex nut and washer (U).

Mounting Instructions for FRS Dispenser to Cart